



**Pump specifications:**

Type.....	BA75 D220
Max. flow .....	440 US GPM (100 m3/hour)
Max. pressure .....	56 ft. / 24 PSI (17 mwc)
Solids handling .....	1,65" (42 mm)
Impeller type .....	Open impeller
Priming system .....	BBA MP50
Engine .....	Hatz 1D90Z
Emission standard .....	Tier 4 final
Canopy .....	L9-15
Connections.....	3" flanges or couplers
Sound level.....	Approx. 54 dB(A) at 33 ft.
Dry weight.....	1925 lbs. (875 kg)

**FEATURES**

**BA auto prime pump**

The BA range of pumps has been designed with a clear focus on reliability, efficiency and durability. Featuring a fully automatic priming system, the BA series pumps quickly prime and re-prime, even from dry conditions. The heavy build style of both pump and canopy make the BA range perfect for use in the demanding construction market.

**World-class performance**

The BA range is built to be deployed on the most demanding applications. Using high efficiency pumps and state-of-the-art diesel engines, the pumps offer maximum performance at minimal cost, fully in-sync with the company philosophy of "Lowest cost of ownership".

**Sustainability**

- High efficiency pumps minimising fuel consumption
- Corrosion free hot dip galvanized canopy
- Corrosion free composite door panels and powder coated plating
- 100% Oil-spill free priming system
- Fully self contained unit featuring a double wall fuel containment tank and fluid containment system eliminating fuel/oil spills at all times

**Complete package designed & built by BBA Pumps**

- Complete in-house design & production
- Over 60 years of experience in the market
- Extensive testing facility in-house
- Contemporary & functional design
- Durable & eco-friendly materials
- Custom builds available

**After sales service & product support**

- Single supplier for parts, spares & accessories
- Dedicated customer help-desk (24h service)
- Dedicated service department in-house
- Global parts distribution network
- Optional global on-site servicing
- Extensive training options available (technical & commercial), on-site or in-house

## PERFORMANCE CURVES (1500 RPM)

Continuous duty according ISO 9906

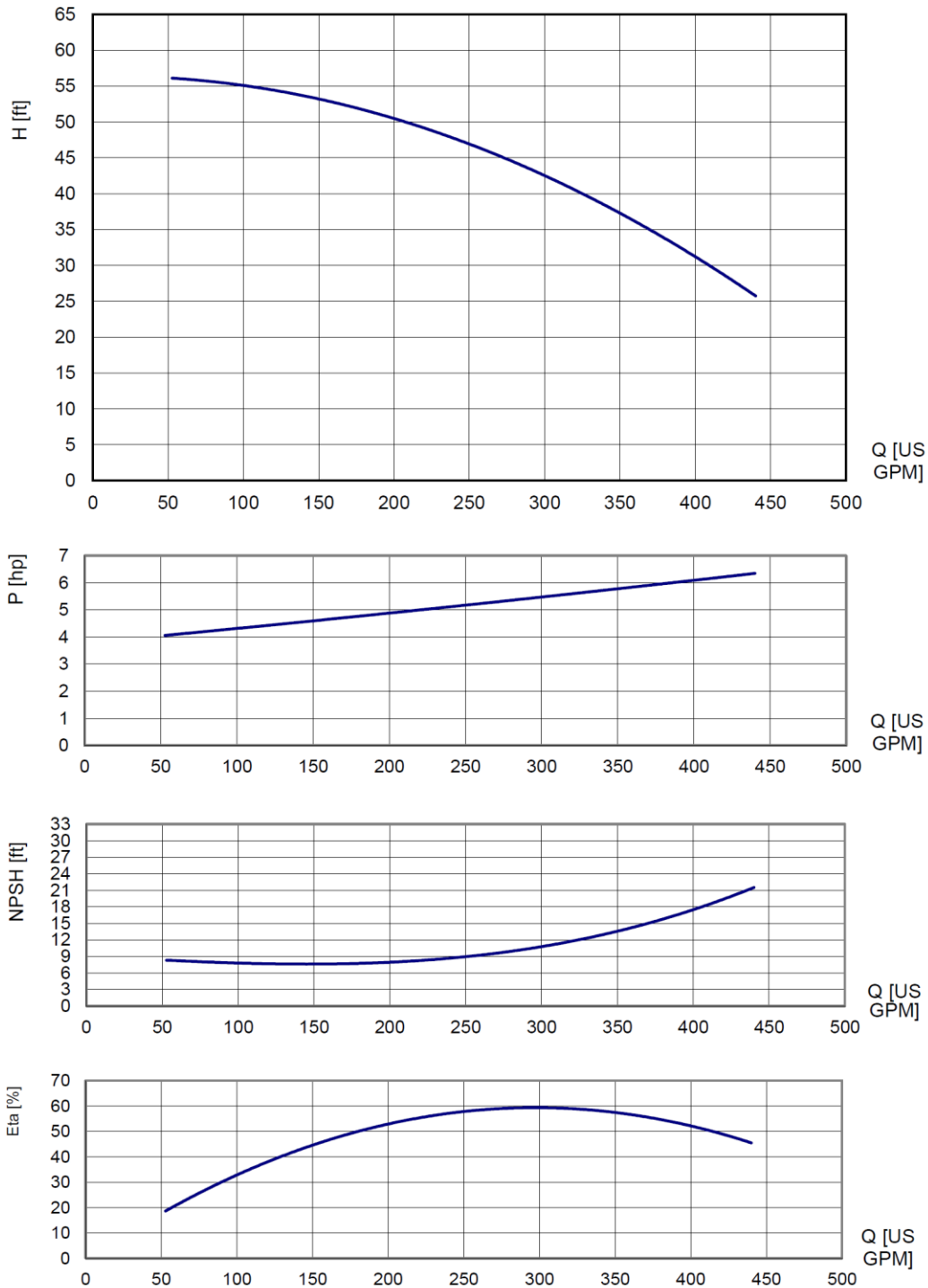

## STANDARD TECHNICAL SPECIFICATIONS

### BBA auto prime pump

Pump type.....	BA75 D220
Max. flow.....	440 US GPM (100 m <sup>3</sup> /hour)
Max. head.....	56 feet / 24 PSI (17 mwc)
Impeller type.....	Open impeller
Solids handling.....	1.65 inch (42 mm)
Pump casing.....	St. 37 galvanized
Impeller.....	Cast iron GG20
Wear plate.....	Cast iron GG20
Pump shaft.....	C45
Shaft seal.....	Mechanical seal
Seal faces.....	Tung/Tung
Seal rubbers.....	Viton



### BBA priming system

Pump type.....	BBA MP50 Diaphragm pump
Air handling capacity.....	30 CFM (50 m <sup>3</sup> /h)
Max. vacuum.....	29 inHg (8.5 m)
Drive.....	Toothed belt (continuous drive)
Float box.....	St. 37 galvanized
Float.....	Stainless steel
Non-return valve.....	Cast iron GG25



### Engine

Engine brand.....	Hatz
Engine type.....	1D90Z electric start
Flywheel power (ICFN).....	7.9 Hp (5.8 kW)
Fixed engine speed.....	1500 RPM
Fuel consumption.....	233 g/kWh
Displacement.....	44 Cubic inch
Number of cylinders.....	1
Cooling system.....	Air cooled
Emission level.....	EPA Tier 4 final

### LOFA dashboard LC20

- Auto start/stop system
- Two float switches included (10m cable)
- Switch Manual-0-Auto
- Tachometer
- Hour counter
- Warning lights "oil and engine temperature"



### Fuel system

- PE fuel tank 32 US Gallon (120 L.) net
- Fuel tank cap Ø 2.5" (60 mm)
- Mechanical fuel injection system
- Fuel filter / water separator

### Electrical system & safety features

- Nominal voltage 12 Volt
- Premium quality battery
- Low oil pressure shut down

## CANOPY L9-15

### BBA Sound Attenuated Canopy

Canopy type.....	L9-15
Dimensions L x W x H .....	59 x 37 x 48,3 inch
Dimensions L x W x H .....	1500 x 940 x 1228 mm
Basic frame.....	Hot dip galvanized
Doors .....	6 easy-access doors (lockable)
Roof panel .....	Composite
Fuel tank .....	Composite net 32 US Gallon (120 ltr)
Fuel tank autonomy .....	85 hours (at 1500 rpm.)
Fuel tank cap .....	2.5 inch (60 mm)
Lifting point .....	Fitted with single lifting point
Forklift pockets.....	Fitted with 2 forklift pockets
Stackable .....	Canopy is stackable
Connections.....	Please consult "auxiliary items"
Exhaust system + DOC .....	Fully integrated in canopy
Documentation box.....	BBA user manual and warranty book

### BBA E-lift® system

The L9-15 canopy has been fitted with the BBA E-lift® system. By removing the roof panel, the pump and diesel engine as a whole can be removed from the canopy effortlessly allowing easy preventative maintenance on the pump and diesel engine. In addition, as the canopy is not fitted with padding or insulation materials, it can be cleaned quickly using a pressure washer.

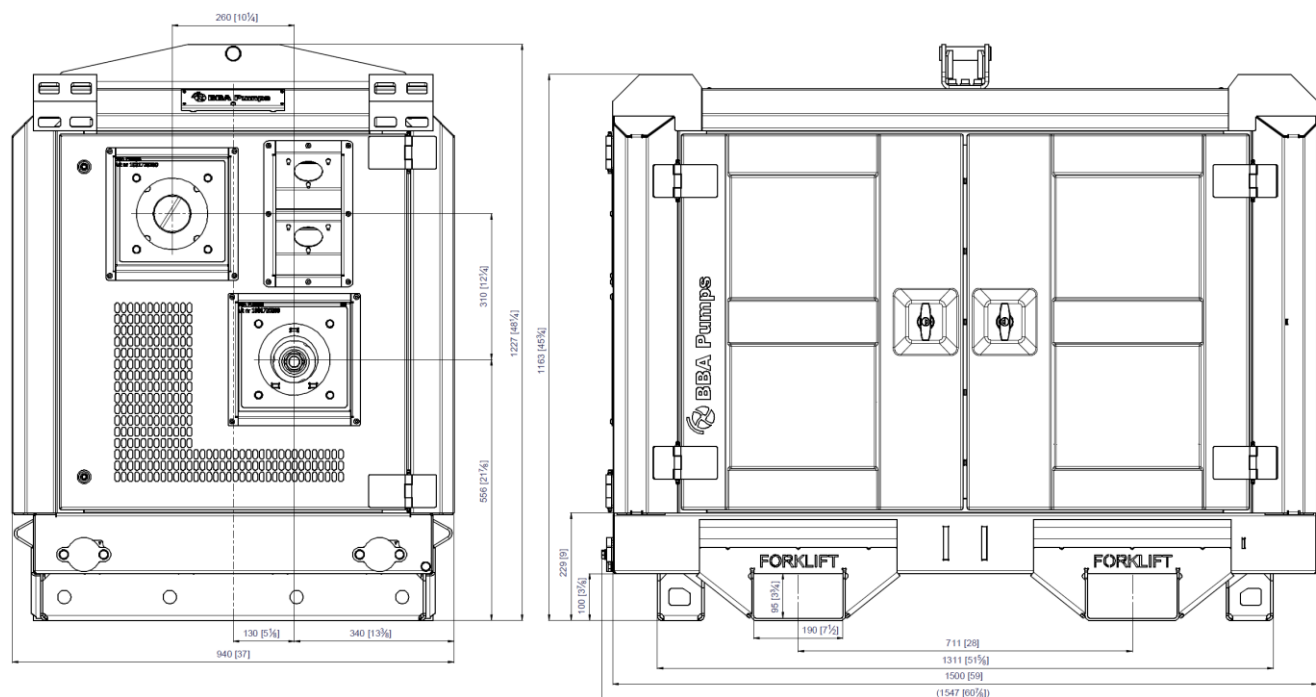

Actual dimensions (in mm & inches) may vary depending on selected quick couplings.

**BA75 Diesel Driven  
Contractor Dewatering Pump**  
Max. 440 US GPM, Max. 56 ft. / 24 PSI

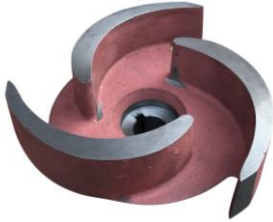

**Open impeller**

Robust open impeller with large 1.65 inch free passage in combination with heavy duty wear plate for a long working life.



**Priming system**

Diaphragm pump, air-cooled, water-resistant and oil-spillage free. Air capacity of 30 CFM.



**Fuel tank**

Fully bundled, corrosion-free, 32 US gallon, high-density polyethylene (HDPE) fuel tank.

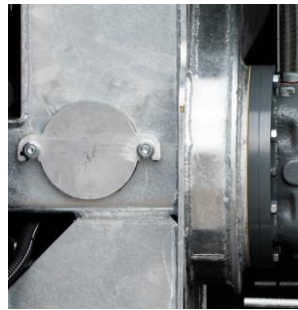

**Large inspection covers**

Easy access to float box, impeller and non-return valve.



**Safety**

Extremely durable and lockable T-locks offering perfect grip.



**4 Year limited warranty**

The BBA limited warranty covers years or operating hours whichever occurs first. For more details please consult the BBA warranty book.

Pictures used are for illustration purposes only.